

Since the usage and finishing of the product is not under our control, we accept no liability for the success of the work and can therefore only guarantee the nature of our products as per the accompanying product data sheets and in accordance with our general terms and conditions of sale. The properties listed here represent no guarantee with respect to the eventual use of our products. We reserve the right to make changes due to technical advances. Any other technical information given in the course of a consultation must be confirmed in writing. Colours shown here are restricted by the printing techniques and may differ from those exhibited by the products themselves. We also reserve the right to make alterations to the product technology or design. Only the current version of this data sheet is valid. Such versions are accessible by anyone via the internet. The issue of the latest data sheet invalidates all those that have been published beforehand.

FLORENTOSTEP

1/2

Staircase profiles – For appealing design in private and public areas

- Information Sheet -



Aluminium / Brass

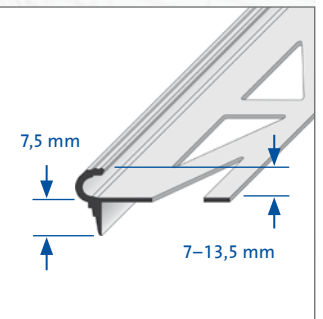
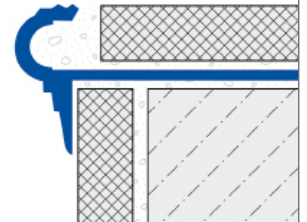

APPLICATION:

FLORENTOSTEP are visually appealing staircase profiles for private areas, business spaces and public buildings. FLORENTOSTEP staircase profiles are especially stress resistant and slide blocking, and they are almost free of wear. This profile ensures optimum walking safety at any time. The edges of the stairs are furthermore permanently protected with the use of FLORENTOSTEP.

MATERIAL:

FLORENTOSTEP staircase profiles are available in the following versions: brass natural, brass high gloss („Star“ with peel-off strip) and chrome plated („Star“ without peel-off strip), aluminium natural, aluminium anodised, stainless steel matt, stainless steel high gloss („Star“ with peel-off strip), and stainless steel polished („Star“ with peel-off strip).

CHARACTERISTIC FEATURES:

FLORENTOSTEP staircase profiles can be used in private as well as in public areas.

FLORENTOSTEP staircase profiles of **brass** can also be used in industrial plants. They resist to major loads and are mostly resistant to chemicals generating during tiling. Important: brass oxidizes when exposed to air, especially with high humidity. The visible surface with time is coated with „patina“ (oxide film) thus changing the appearance.

FLORENTOSTEP stair case profiles made of **brass with a chrome finish** are extremely resistant to mechanical loading. They should not be allowed to come into contact with products that contain salt or hydrofluoric acid, however, since these will damage the surface. To ensure that the high gloss finish of the chrome layer is not impaired, residues of mortar and jointing compounds should be removed from the surface immediately.

FLORENTOSTEP staircase profiles of **aluminium** can be used for all areas where no exceptional chemical reactions are to be expected. Careful handling of cement material is required to avoid corrosion. Any residues of mortar, tile cement or joint cement are to be immediately removed

Stainless steel

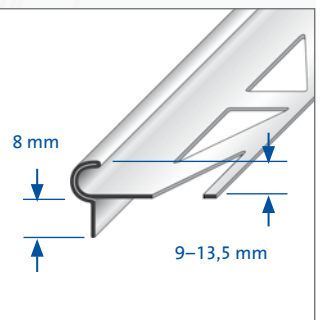
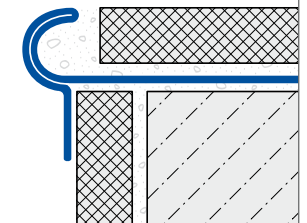

DURAL GmbH

Südring 11

D-56412 Ruppach-Goldhausen

Tel. +49 (0) 2602/9261-0

Fax +49 (0) 2602/9261-50

info@dural.com

Staircase profiles – For appealing design in private and public areas

- Information Sheet -

from all visible surfaces because aluminium is sensitive to alkaline mediums. The profile is to be completely embedded into the contact layer. This avoids the formation of cavities where alkaline water might accumulate.

FLORENTOSTEP staircase profiles of **anodised aluminium** are especially refined which usually prevents any change of the surface. However, the visible surfaces have to be protected against cement materials. Damages might also generate due to scratching or abrasive objects.

FFLORENTOSTEP staircase profiles of **stainless steel** are especially appropriate for application areas subjected to major stresses because of chemicals and acids. Also with respect to mechanical load these profiles meet the highest requirements. Profiles of special steel are used in the foodstuff industry, hospitals, swimming-pools and breweries.

For all products and materials, the following applies: The suitability of the material with regard to the expected mechanical loading and chemical exposure must be investigated carefully in each individual case. The generally recognised rules of good engineering practice must always be observed!

HANDLING:

1. Select the FLORENTOSTEP staircase profile according to tile thickness.
2. Place the covering material according to height of the raiser.
3. Apply tile cement in the edge area using a toothed tiling trowel.
4. Press carrier profile tightly into the cement bed and align the front edge flush with the raiser tile.
5. Completely cover the fastening sides with cement.
6. Press the joining tiles tightly in and align them flush with the upper profile edge. Place tiles well embedded.
7. Leave a joint of 2-3 mm between profile and tile
8. Completely fill the space between tiles and profile with joint cement.

MAINTENANCE:

FLORENTOSTEP staircase profiles do not require any special care. Oxidation layers on brass and aluminium profiles can be removed with using polishing solutions. A permanent removal however, is not possible because it will generate again. Damages of the anodised layer have to be varnished, if required.

For profiles of special steel it is recommended to use chrome polishing solution. It will provide for a bright appearance. Special steel profiles exposed to very aggressive mediums should be cleaned from time to time with mild cleaning materials. This will reduce the danger of corrosion. The cleaning materials have to be free from hydrochloric acid and hydrofluoric acid and must not be abrasive.

PRODUCT DATA:

MATERIAL:	Aluminium natural, anodised / Brass natural, high gloss polished („Star“ with peel-off strip), chrome / Stainless steel natural, high gloss polished („Star“ with peel-off strip), brushed („Star“ with peel-off strip)
HEIGHT:	Aluminium = 7 / 9 / 11 / 13,5 mm, Brass = 7 / 9 / 11 mm, Stainless steel = 9 / 11 / 13,5 mm
LENGTH:	100 cm, 250 cm
ACCESSORIES (Alu):	External corner / Internal corner / End cap left / End cap right



DURAL GmbH

Südring 11

D-56412 Ruppach-Goldhausen

Tel. +49 (0) 2602/9261-0

Fax +49 (0) 2602/9261-50

info@dural.com