

Since the usage and finishing of the product is not under our control, we accept no liability for the success of the work and can therefore only guarantee the nature of our products as per the accompanying product data sheets and in accordance with our general terms and conditions of sale. The properties listed here represent no guarantee with respect to the eventual use of our products. We reserve the right to make changes due to technical advances. Any other technical information given in the course of a consultation must be confirmed in writing. Colours shown here are restricted by the printing techniques and may differ from those exhibited by the products themselves. We also reserve the right to make alterations to the product technology or design. Only the current version of this data sheet is valid. Such versions are accessible by anyone via the internet. The issue of the latest data sheet invalidates all those that have been published beforehand.

DURAGARD

1/2

Metal corner protection profiles for subsequent installation

- Information Sheet -

DURAL



Stainless steel

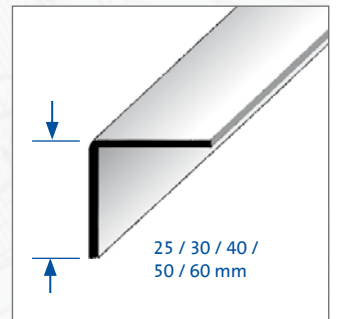
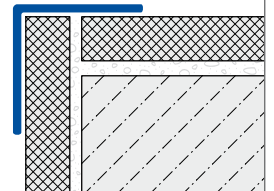

Stainless steel

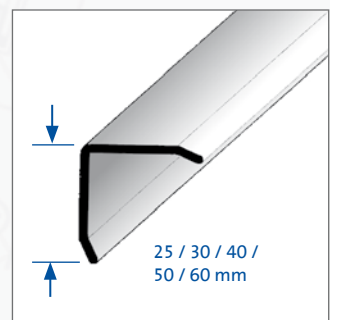
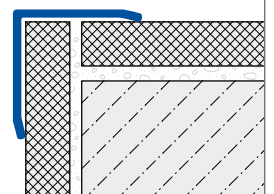

APPLICATION:

DURAGARD corner protection profiles from Dural are extremely sophisticated corner profiles made of stainless steel, anodised or powder-coated aluminium. They were specially developed to protect tiled corners and edges submitted to major loads and stresses. DURAGARD profiles are also ideal for industrial areas where stringent hygienic requirements are in place, for example kitchens and catering or commercial kitchens.

MATERIAL:

DURAGARD corner protection profiles are made of V2A stainless steel (1.4301) with a protective film, anodised aluminium or powder-coated aluminium.

PROPERTIES:

DURAGARD stainless steel corner protection profiles are ideal for areas which are subject to high loads and stresses. This also includes chemicals and acids. They also satisfy the highest mechanical requirements. Stainless steel profiles are used in areas such as the food industry, hospitals, swimming pools and breweries.

DURAGARD corner protection profiles in anodised aluminium and powder-coated aluminium have a special finish, which means the surface does not generally change. The visible surfaces must be protected from cement materials. Damage can occur due to abrasive, scratching or grinding objects.

The following information is applicable to all products/materials: the suitability of the profile with respect to mechanical and chemical loads must be checked carefully in each individual installation case. The generally accepted regulations of technology and good engineering practice must always be observed.

DURAL GmbH

Südring 11

D-56412 Ruppach-Goldhausen

Tel. +49 (0) 2602/9261-0

Fax +49 (0) 2602/9261-50

info@dural.com

Metal corner protection profiles for subsequent installation

- Information Sheet -

PROCESSING:

For subsequent bonding:

1. Clean any dirt from the wall surface
2. Apply silicone to the insides of the corner profile
3. Press the DURAGARD corner protection profile flush onto the edge and secure against slipping if necessary until the adhesive is dry
4. Remove any silicone emerging from under the edges with detergent
5. For stainless steel profiles, remove the protective film

CARE:

Chrome polish is recommended for stainless steel profiles, as it leaves a glossy finish. If stainless steel profiles are exposed to extremely aggressive media, they should be cleaned occasionally using a mild detergent. Detergents must be non-abrasive and free from hydrochloric or hydrofluoric acid.

The use of chrome polish is recommended for stainless steel profiles. Oxidation layers on aluminium profiles can be removed using polishing solutions, however, permanent removal is not possible.

Aluminium

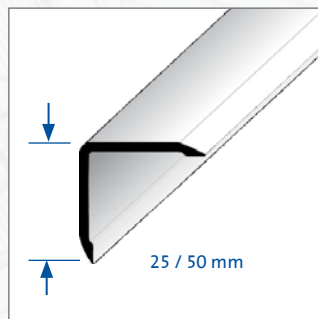
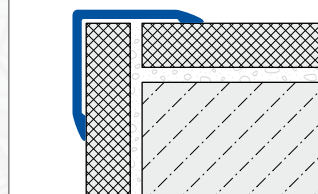

PRODUCT DATA:

MATERIAL:	<ul style="list-style-type: none"> - Aluminium, anodised, silver, gold - Aluminium, powder-coated, white - Stainless steel, matt (with protective film) - Stainless steel, finely ground (240 K) (with protective film) - Stainless steel, high-gloss (with protective film)
LENGTH:	250 cm
MATERIAL THICKNESS:	Aluminium = 2 mm, Stainless steel = 1 mm
WIDTH:	Aluminium = 25 x 25 / 50 x 50 mm Stainless steel = 25 x 25 / 30 x 30 / 40 x 40 / 50 x 50 / 60 x 60 mm
INTENDED USE:	Corner protection profiles for subsequent installation

DURAL GmbH

Südring 11

D-56412 Ruppach-Goldhausen

Tel. +49 (0) 2602/9261-0

Fax +49 (0) 2602/9261-50

info@dural.com