

BALCONIES · TERRACES DOORMAT SYSTEMS

DURAL

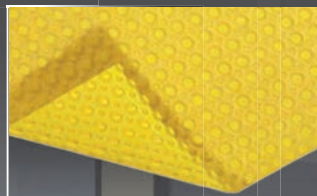
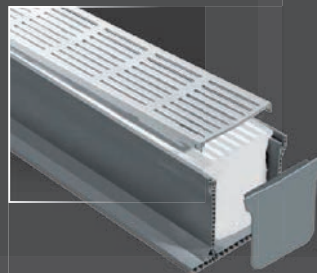
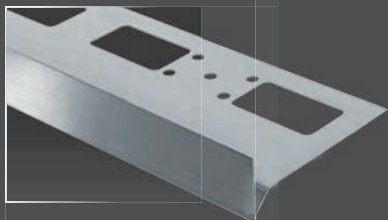

Balcony angle profiles
DURABAL

Decoupling
DURABASE CI++

Drainage
DURABASE DD 80++
DURABASE DD 80

Drainage channel system
U-DRAIN
DW-DRAIN

Installation materials

Doormat system
DURAWAY

	Page
Height-adjustable boundary profiles for different types of installation DURABAL ST	4 – 5
Angle profiles for different types of installation DURABAL BL / BT	6 – 7
Angle profiles for installation in thick-bed adhesive DURABAL BS	8 – 9
Angle profiles for installation in thin-bed adhesive DURABAL BK	10 – 11
DURABAL BT 11	12 – 13
DURABAL BT 3	12 – 13
DURABAL BD	14 – 15
DURABAL BW	16 – 17
Drainage mats DURABASE DD 80++	18
DURABASE DD 80	19
Decoupling mat DURABASE CI++	20 – 21
Drainage channel system U-DRAIN	22 – 23
Design Drainage channel system DW-DRAIN	24
Installation materials SUPPORT PLATES/TILE SPACERS	25
Doormat and frame system DURAWAY	26 – 27

Beautiful views for the house and garden.

For over 30 years, DURAL has been your expert for profile and mat systems, including solutions for the garden and landscaping, as well extended outdoor areas.

When renovating your balcony, giving entry areas a new look with safety in mind, finishing your terrace with loosely laid modern terrace flooring or to meet the goal of making houses fit for the next generation, the coordinated DURAL product components are a good choice.

The diversity of our products provides inspiration for beautiful views in your house and garden.

PROFILE
SYSTEMS
BALCONIES · TERRACES
DOORMAT SYSTEMS

Two-piece, height-adjustable boundary profile in gravel / chipping, drainagemortar, on supports with plug-in-profile or for direct laying

DURABAL ST

DURABAL ST

For terrace and balcony surfaces with installation heights of 30 to 120 mm.

Height-adjustable

External corners and connectors

Brushed stainless steel (316)

Internal drainage

Also applicable as a gravel strip

Internal drainage



DURABAL ST

Two-piece, height-adjustable boundary profile for terraces and balconies. With drip edge and internal drainage.

DURABAL ST Base profile

Material Stainless steel (316) brushed

Balcony flange 120 mm
Length 250 cm

STE 30-SF Installation height 30 mm

STE 60-SF Installation height 60 mm

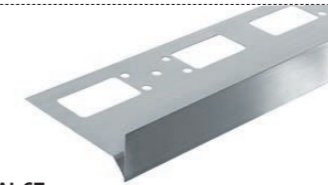

DURABAL ST Plug-in profile

For the height adjustment of DURABAL ST base profiles

Material Stainless steel (316) brushed

Length 250 cm

STE 30-SF-XA Installation height 30 mm

STE 45-SF-XA Installation height 45 mm

STE 60-SF-XA Installation height 60 mm

STE 75-SF-XA Installation height 75 mm



DURABAL ST External corner

Material Stainless steel (316) brushed

Balcony flange 120 mm
Length 295 x 295 mm

STE 30-SF-X Installation height 30 mm

STE 60-SF-X Installation height 60 mm

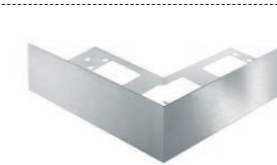

DURABAL ST Corner plug-in profile

For the height adjustment of DURABAL ST external corners

Material Stainless steel (316) brushed

Length 80 x 80 mm

STE 30-SF-XE Installation height 30 mm

STE 45-SF-XE Installation height 45 mm

STE 60-SF-XE Installation height 60 mm

STE 75-SF-XE Installation height 75 mm



DURABAL ST Connector

Material Stainless steel (316) brushed

Length 35 mm

STE 45-SF-XC Installation height 45 mm

STE 75-SF-XC Installation height 75 mm



DURABAL ST Installation heights

Base profile	Plug-in profile	max. height
STE 30-SF	STE 30-SF-XA	32 - 45 mm
STE 30-SF	STE 45-SF-XA	32 - 60 mm
STE 30-SF	STE 60-SF-XA	42 - 75 mm
STE 30-SF	STE 75-SF-XA	57 - 90 mm
STE 60-SF	STE 30-SF-XA	62 - 75 mm
STE 60-SF	STE 45-SF-XA	62 - 90 mm
STE 60-SF	STE 60-SF-XA	62 - 105 mm
STE 60-SF	STE 75-SF-XA	62 - 120 mm

DURABAL ST Installation options

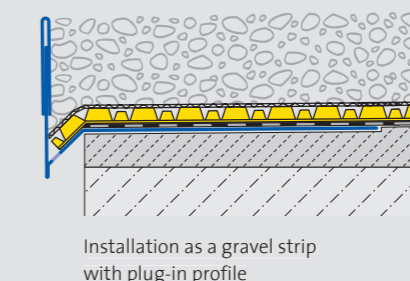
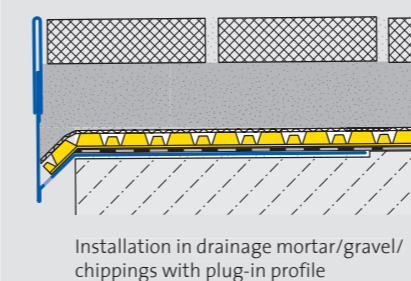
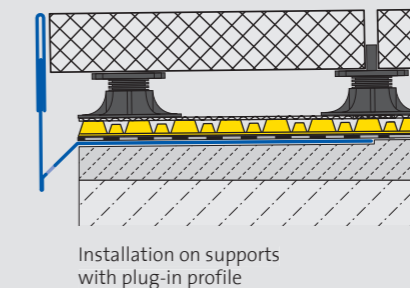
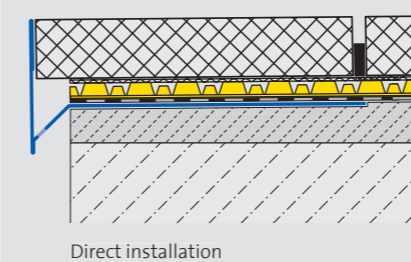

DURABAL ST Structural options

PLUG-IN PROFILE

30 mm
45 mm
60 mm
75 mm

BASE PROFILE

Balcony flange 120 mm

30 mm
60 mm

19 mm

15 mm



DURABAL BL/ BT

DURABAL BL/BT are balcony angle profiles with a drip edge for the elegant edging of exposed edge areas of surface constructions. The front edge cover in various heights also conceals higher layered structures between the subsurface and the flooring.

Areas of application of DURABAL BL are balconies and terraces, for installation in gravel / stone bed, drainage screed, on stilt bearings for raised floors or for direct laying. Drainage slots provide straightforward secondary drainage, thereby preventing the build-up of stagnant water within the floor construction.

DURABAL BT applies to surface constructions laid in a conventional mortar bed. As required, the underside of the surface structure can be clad using the matching DURABAL BW profiles.



DURABAL BL / BT

Balcony angle profiles with drip edge and edge protection.
With or without drip sill.

Angle profile with drip edge for installation in gravel / stone bed, drainage screed, on stilt bearings for raised floors or for direct laying

DURABAL BL / BT

DURABAL BL Base profile

with additional drill holes, with drip sill

Material Aluminium, * powder coated

Base size 100 mm

Length 300 cm

Installation height 28 mm

BLAE 530 silver anodised

BLAC 5338 RAL 7035 grey*

Installation height 35 mm

BLAE 600 silver anodised

BLAC 6038 RAL 7035 grey*

Installation height 40 mm

BLAE 650 silver anodised

BLAC 6538 RAL 7035 grey*

Installation height 70 mm

BLA 950 natural

BLAE 950 silver anodised

BLAC 9538 RAL 7035 grey*

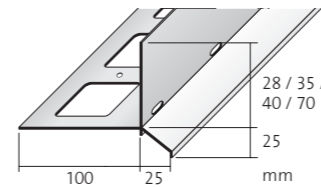

DURABAL BT Base profile

with additional drill holes, without drip sill

Material Aluminium powder coated

Base size 100 mm

Length 300 cm

Installation height 40 mm

BTAC 6532 RAL 1019 beige

BTAC 6533 RAL 8019 black-brown

BTAC 6535 RAL 8003 brown

BTAC 6538 RAL 7035 grey

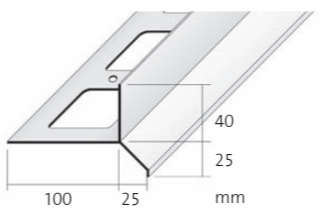

DURABAL BL Corner piece

Material Aluminium, * powder coated

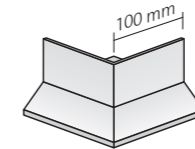

Installation height 28 mm

BLAE 530-X silver anodised

BLAC 5338-X RAL 7035 grey*

Installation height 35 mm

BLAE 600-X silver anodised

BLAC 6538-X RAL 7035 grey*

Installation height 40 mm

BLAE 650-X silver anodised

BLAC 6538-X RAL 7035 grey*

Installation height 70 mm

BLA 950 natural

BLAE 950-X silver anodised

BLAC 9538-X RAL 7035 grey*

DURABAL BT Corner piece

Material Aluminium powder coated

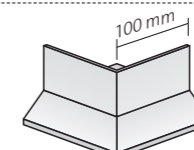

Installation height 40 mm

BTAC 6532-X RAL 1019 beige

BTAC 6533-X RAL 8019 black-brown

BTAC 6535-X RAL 8003 brown

BTAC 6538-X RAL 7035 grey



DURABAL BL Connector

Material Aluminium, * powder coated

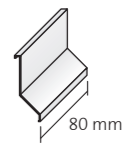

Installation height 28 mm

BLAE 530-XC silver anodised

BLAC 5338-XC RAL 7035 grey*

Installation height 35 mm

BLAE 600 silver anodised

BLAC 6038-XC RAL 7035 grey*

Installation height 40 mm

BLAE 650-XC silver anodised

BLAC 6538-XC RAL 7035 grey*

Installation height 70 mm

BLA 950-XC natural

BLAE 950-XC silver anodised

BLAC 9538-XC RAL 7035 grey*

DURABAL BT Connector

Material Aluminium powder coated

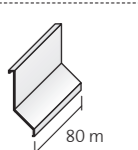

Installation height 40 mm

BTAC 6532-XC RAL 1019 beige

BTAC 6533-XC RAL 8019 black-brown

BTAC 6535-XC RAL 8003 brown

BTAC 6538-XC RAL 7035 grey

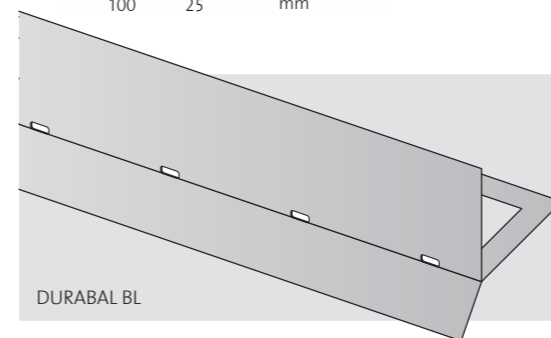

DURABAL BL

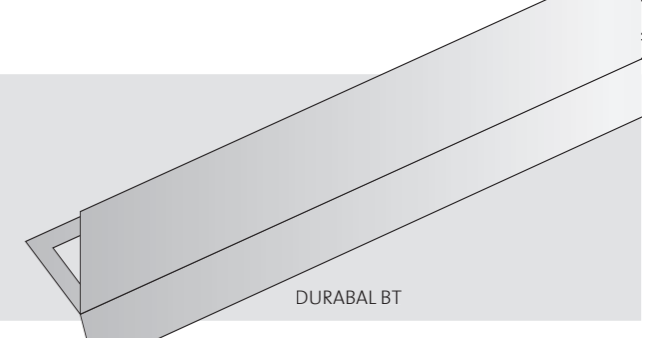

DURABAL BT



DURABAL BS

T-shaped balcony angle profiles without a drip edge for the elegant edging of open edge areas of surface constructions laid in a conventional mortar bed.

Available in a wide range of RAL colours, they fit harmoniously in the overall decorative scheme.

As required, the underside of the surface structure can be clad using the matching DURABAL BW profiles.

DURABAL BS

T-shaped angle profile for balconies and terraces, without drip edge.

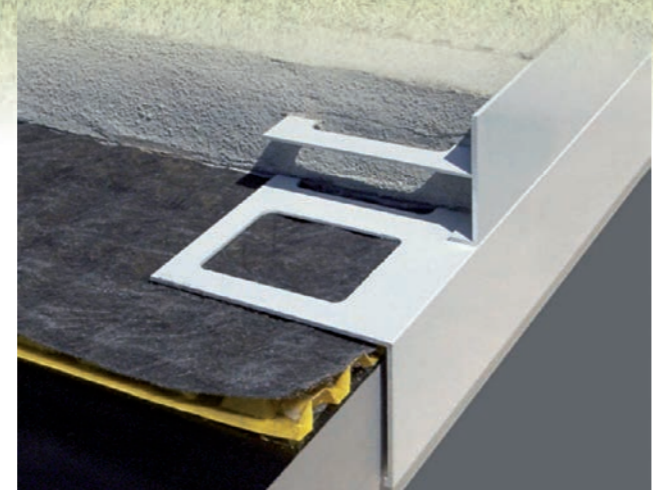

T-shaped angle profile for installation in **thick-bed adhesive**

DURABAL BS

DURABAL BS Base profile
with additional drill holes
Material Aluminium powder coated
Base size 80 mm

Length 250 cm, Height 55 mm

BSAC 5532	RAL 1019 beige
BSAC 5533	RAL 8019 black-brown
BSAC 5535	RAL 8003 brown
BSAC 5538	RAL 7035 grey

Length 250 cm, Height 75 mm

BSAC 7532	RAL 1019 beige
BSAC 7533	RAL 8019 black-brown *
BSAC 7535	RAL 8003 brown
BSAC 7538	RAL 7035 grey *

Length 300 cm, Height 75 mm

BSAC 7533	RAL 8019 black-brown
BSAC 7538	RAL 7035 grey

*) discontinued article

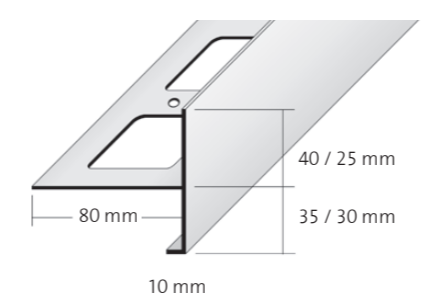

DURABAL BS Corner piece
Material Aluminium powder coated

Height 55 mm

BSAC 5532-X	RAL 1019 beige
BSAC 5533-X	RAL 8019 black-brown
BSAC 5535-X	RAL 8003 brown
BSAC 5538-X	RAL 7035 grey

Height 75 mm

BSAC 7532-X	RAL 1019 beige
BSAC 7533-X	RAL 8019 black-brown
BSAC 7535-X	RAL 8003 brown
BSAC 7538-X	RAL 7035 grey

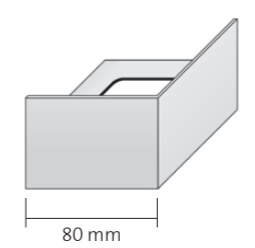

DURABAL BS Connector
Material Aluminium powder coated

Height 55 mm

BSAC 5532-XC	RAL 1019 beige
BSAC 5533-XC	RAL 8019 black-brown
BSAC 5535-XC	RAL 8003 brown
BSAC 5538-XC	RAL 7035 grey

Height 75 mm

BSAC 7532-XC	RAL 1019 beige
BSAC 7533-XC	RAL 8019 black-brown
BSAC 7535-XC	RAL 8003 brown
BSAC 7538-XC	RAL 7035 grey

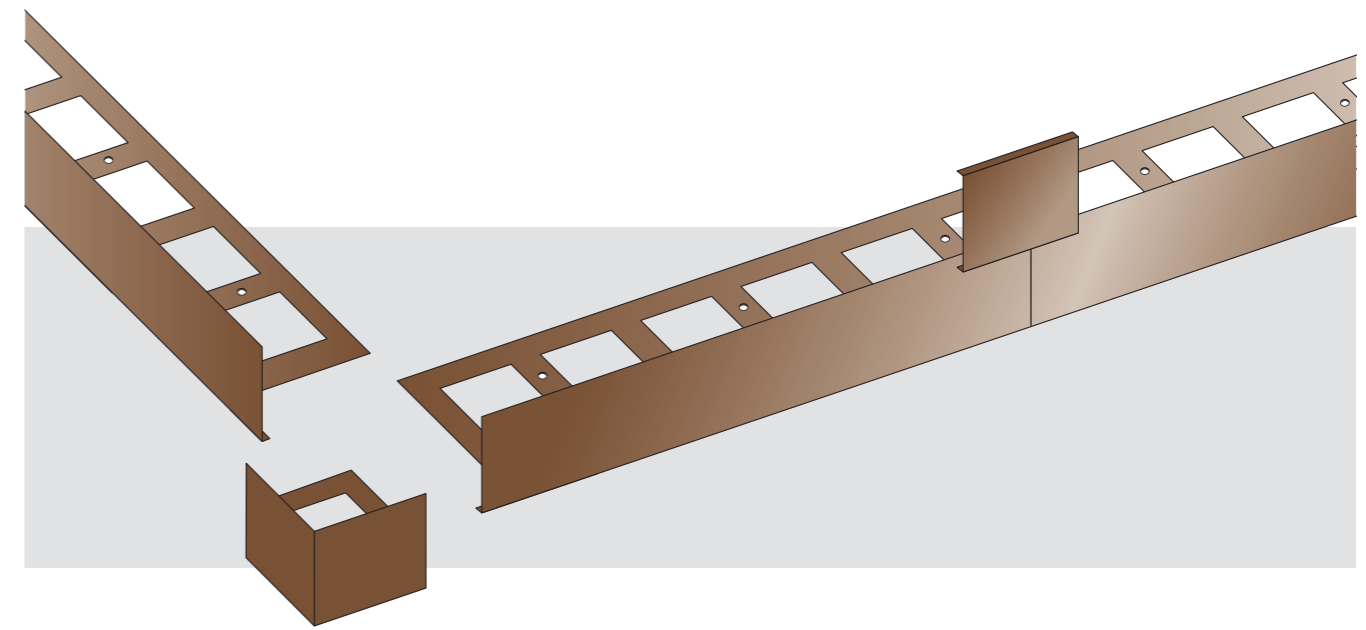
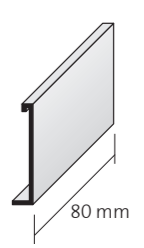

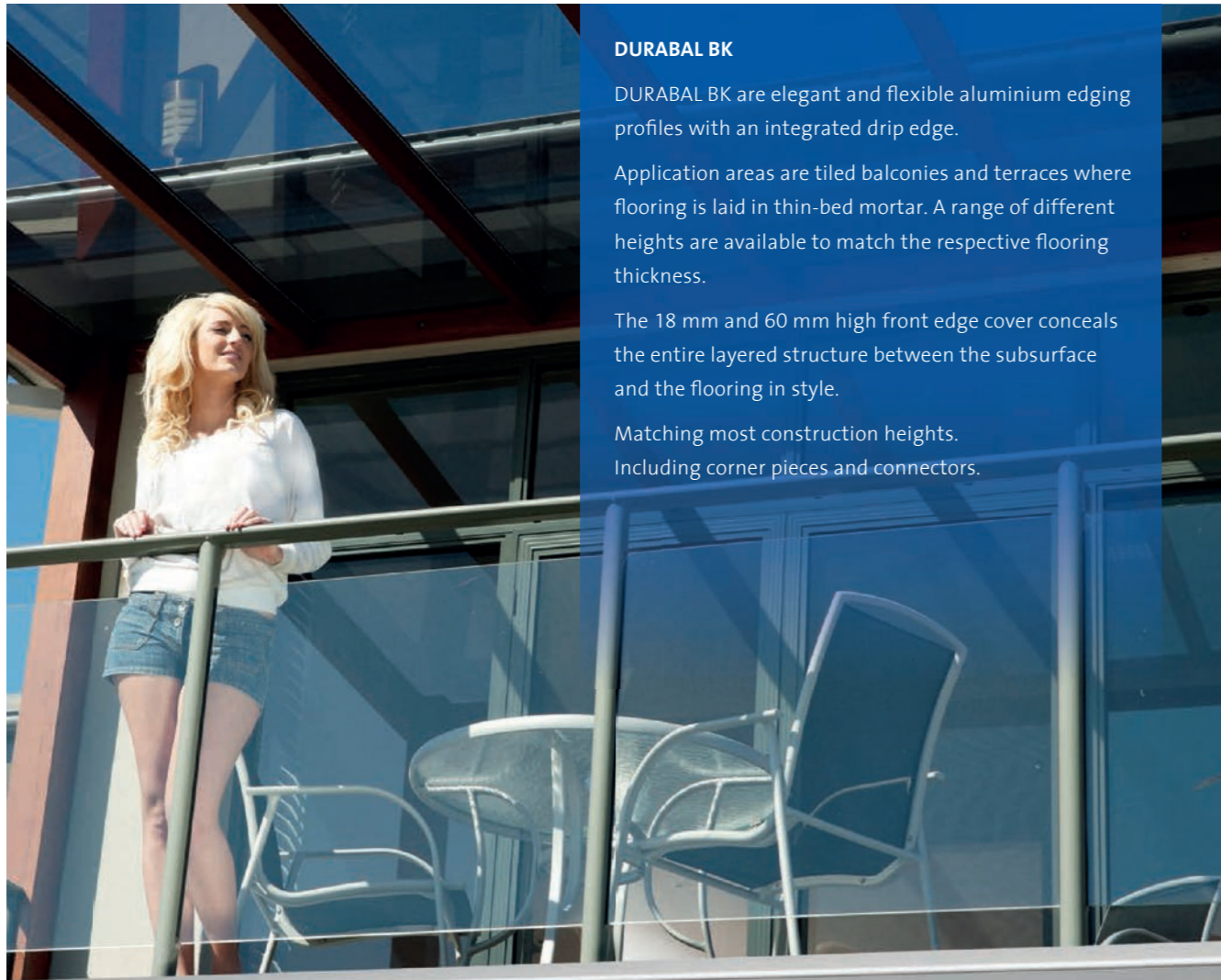

DURABAL BK

DURABAL BK are elegant and flexible aluminium edging profiles with an integrated drip edge.

Application areas are tiled balconies and terraces where flooring is laid in thin-bed mortar. A range of different heights are available to match the respective flooring thickness.

The 18 mm and 60 mm high front edge cover conceals the entire layered structure between the subsurface and the flooring in style.

Matching most construction heights. Including corner pieces and connectors.



Illustration: DURABAL BK cover height 18 mm

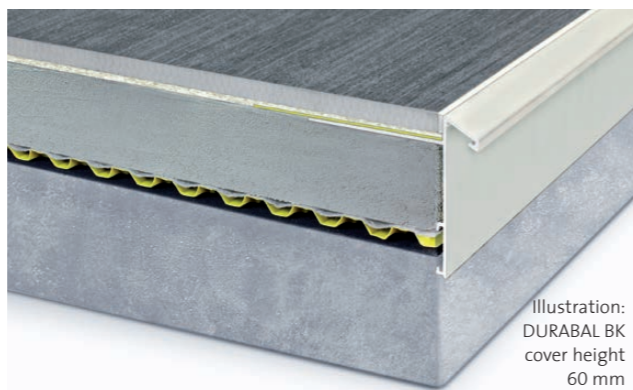

Illustration: DURABAL BK cover height 60 mm

DURABAL BK

Balcony angle profile with drip edge and cover. Height Flexible and shapely.

Angle profile with drip edge for installation in thin-bed adhesive

DURABAL BK

DURABAL BK Base profile

Material Aluminium anodised silver
undrilled

Cover height 18 mm

Length 300 cm

BKAE 90	Installation height 9 mm
BKAE 110	Installation height 11 mm
BKAE 130	Installation height 13 mm

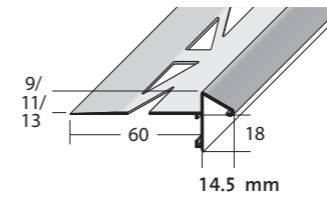

DURABAL BK External corner

Material Aluminium silver

BKAE-XH Installation height 9 – 13 mm

Cover height 18 mm

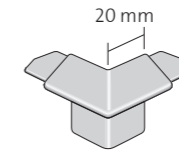

DURABAL BK Internal corner

Material Aluminium silver

BKAE-XIH Installation height 9 – 13 mm

Cover height 18 mm

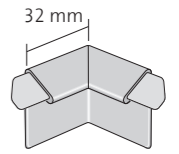

DURABAL BK Base profile

Material Aluminium anodised silver

Length 300 cm

Cover height 60 mm

undrilled

BKAE 90-60	Installation height 9 mm
BKAE 110-60	Installation height 11 mm
BKAE 130-60	Installation height 13 mm

drilled

BKAE 90-60 GB	Installation height 9 mm
BKAE 110-60 GB	Installation height 11 mm
BKAE 130-60 GB	Installation height 13 mm

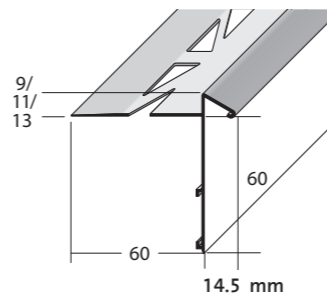

DURABAL BK External corner

Material Aluminium silver

BKAE 60-XH Installation height 9 – 13 mm

Cover height 60 mm



DURABAL BK Internal corner

Material Aluminium silver

BKAE 60-XIH Installation height 9 – 13 mm

Cover height 60 mm

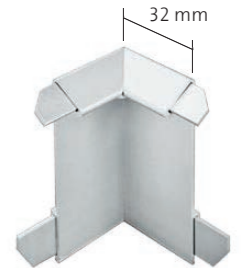

DURABAL BK

Connector for all BK-Profiles

Material Aluminium natural

Width 60 mm

BKA 1000-XC

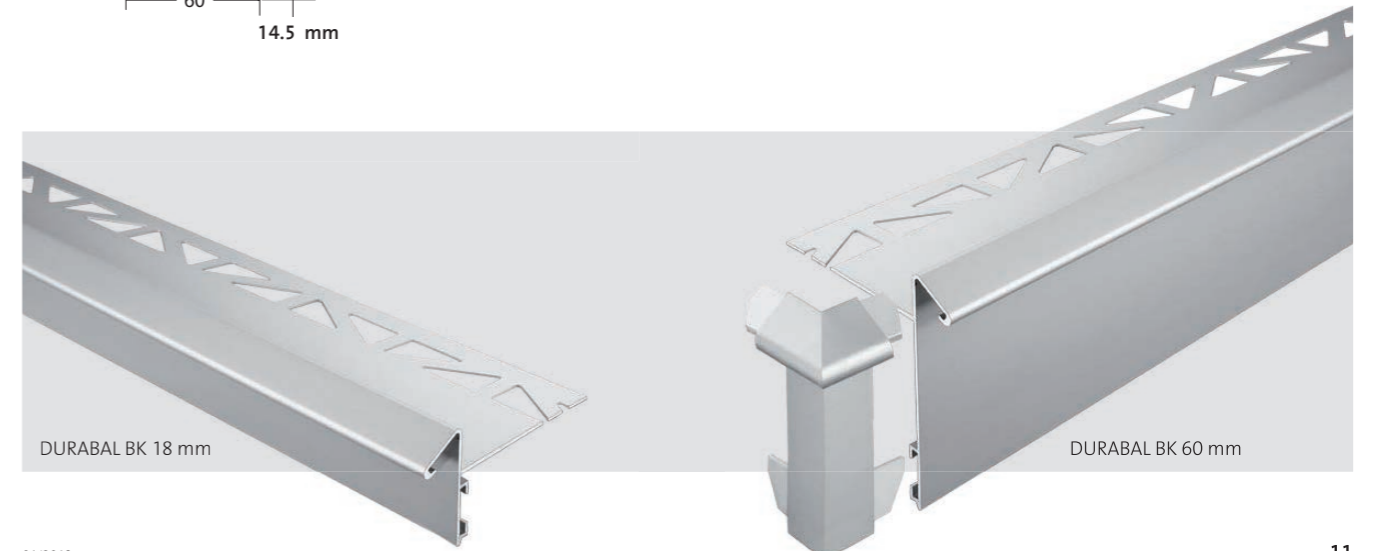

DURABAL BK 18 mm

DURABAL BK 60 mm



DURABAL BT 11 / BT 3

DURABAL BT are balcony angle profiles with a drip edge for the elegant edging of exposed edge areas of surface constructions laid in a conventional mortar bed. Available in a wide range of RAL colours, they fit harmoniously in the overall decorative scheme.

DURABAL BT 3 Balcony angle profile with drip edge for surfaces with coatings.



Illustration:
DURABAL BT 3
with grit binder

DURABAL BT 11
BT 3

Balcony angle profile with drip edge and cover for installation in thin-bed adhesive.

Angle profile with drip edge for installation in thin-bed adhesive

DURABAL BT 11 / BT 3

DURABAL BT 11 Base profile

with additional drill holes

Material Aluminium

Base size 100 mm

**Length 300 cm,
Installation height 11 mm**

BTAC 7238-11 grey powder coated

BTAE 72-11 silver anodised

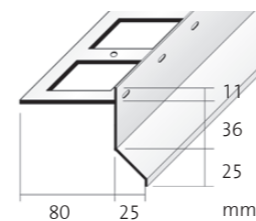

DURABAL BT 11 Corner piece

Material Aluminium

Installation height 11 mm

BTAC 7238-11 grey powder coated

BTAE 72-11-X silver anodised

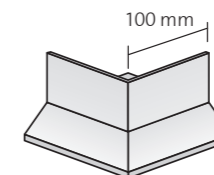

DURABAL BT 11 Connector

Material Aluminium

Installation height 11 mm

BTAC 7238-11-XC grey powder coated

BTAE 72-11-XC silver anodised

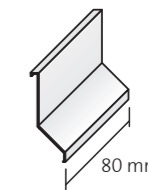

DURABAL BT 3 Base profile

with additional drill holes

Material Aluminium powder coated

Base size 100 mm

**Length 250 cm,
Installation height 3 mm**

BTAC 332 RAL 1019 beige

BTAC 333 RAL 8019 black-brown

BTAC 335 RAL 8003 brown

BTAC 338 RAL 7035 grey

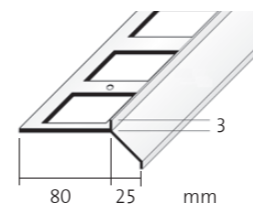

DURABAL BT 3 Corner piece

Material Aluminium powder coated

Installation height 3 mm

BTAC 332-X RAL 1019 beige

BTAC 333-X RAL 8019 black-brown

BTAC 335-X RAL 8003 brown

BTAC 338-X RAL 7035 grey

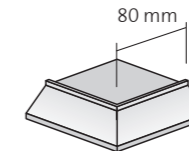

DURABAL BT 3 Connector

Material Aluminium powder coated

Installation height 3 mm

BTAC 332-XC RAL 1019 beige

BTAC 333-XC RAL 8019 black-brown

BTAC 335-XC RAL 8003 brown

BTAC 338-XC RAL 7035 grey

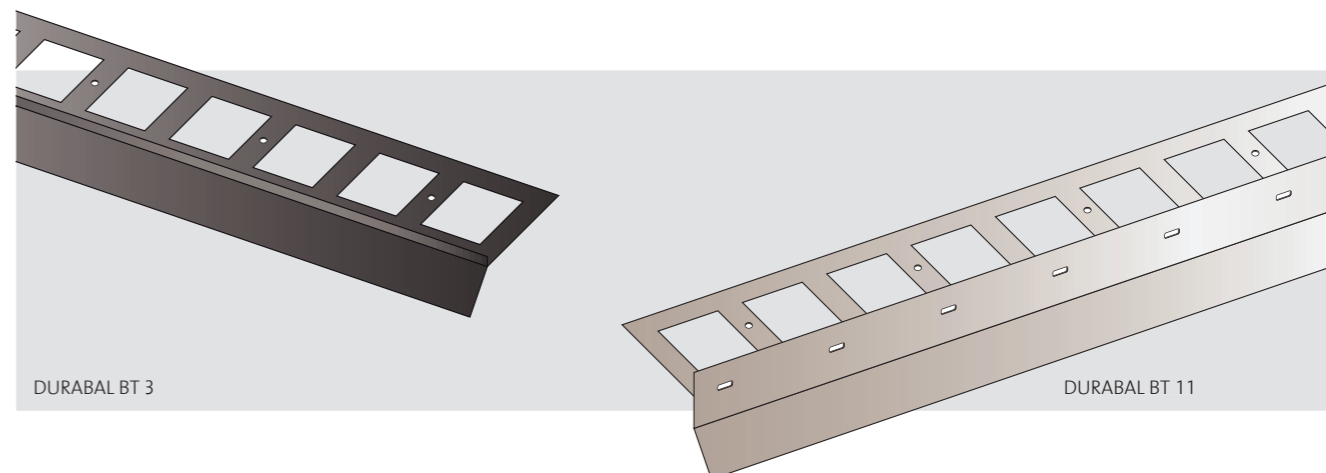
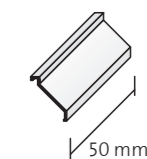



DURABAL BD

DURABAL BD balcony angle profiles for a smooth finish and as cladding for balconies and terrace edge areas are suitable for the installation of tile, natural stone or split mortar flooring up to an installation height of 15 mm.

Bitumen waterproofing can be elegantly finished with DURABAL BD balcony angle profiles.

DURABAL BD comes in versions with 55 mm and 75 mm high panels and is available in silver anodized aluminium and powder-coated grey surface finishes.

The 80 m wide support base is provided with additional drill holes to make mounting during assembly easier.

DURABAL BD

Balcony angle profile with smooth T-shape finish for elegant frames and edge protection of tile and natural stone flooring in outdoor areas.

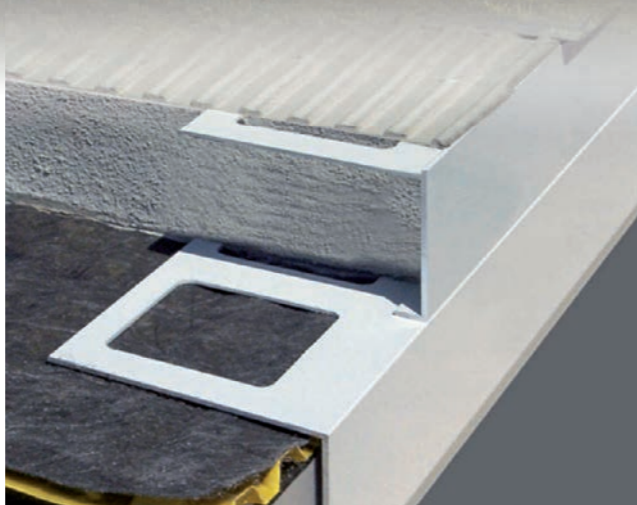

T-shaped angle profile for installation in thin-bed adhesive

DURABAL BD

DURABAL BD Base profile

with additional drill holes

Material Aluminium

Base size 80 mm

Length 300 cm

Aluminium grey powder coated

BDAC 5538-15 Installation height 15 mm

BDAC 7538-11 Installation height 11 mm

DURABAL BD Corner piece

Material Aluminium

Aluminium grey powder coated

BDAC 5538-15-X Installation height 15 mm

BDAC 7538-11-X Installation height 11 mm

DURABAL BD Connector

Material Aluminium

Aluminium grey powder coated

BDAC 5538-15-XC Installation height 15 mm

BDAC 7538-11-XC Installation height 11 mm

Length 300 cm

Aluminium silver anodised

BDAE 55-15 Installation height 15 mm

BDAE 75-11 Installation height 11 mm

Aluminium silver anodised

BDAE 55-15-X Installation height 15 mm

BDAE 75-11-X Installation height 11 mm

Aluminium silver anodised

BDAE 55-15-XC Installation height 15 mm

BDAE 75-11-XC Installation height 11 mm

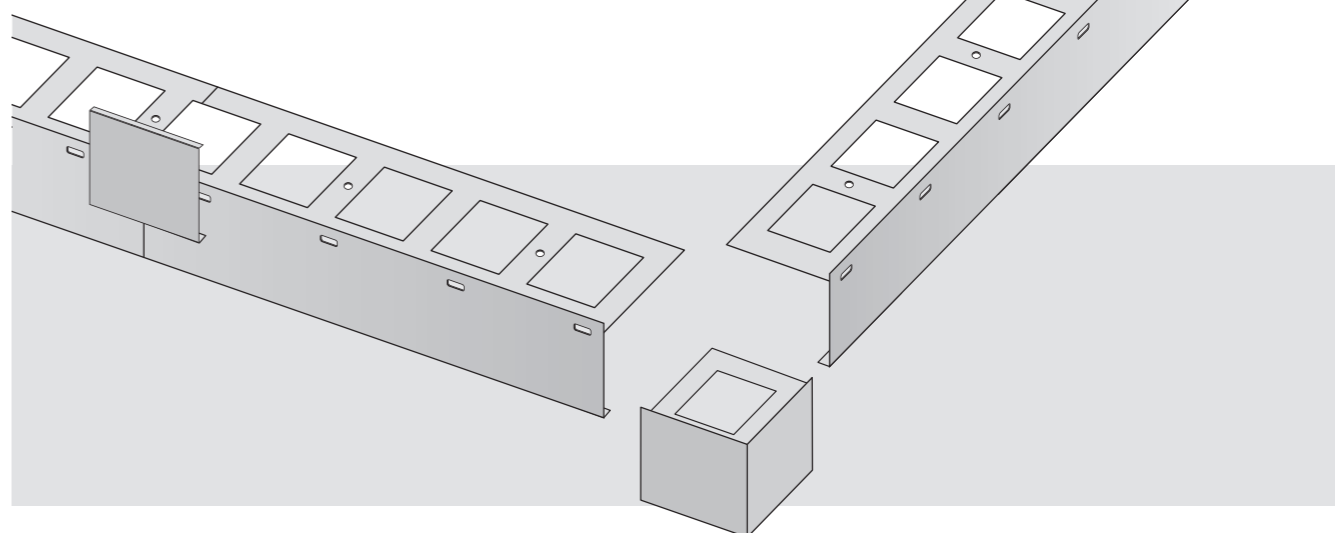
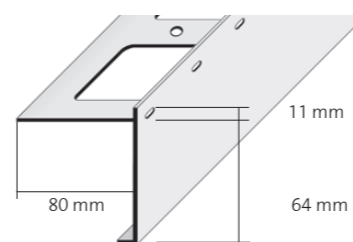
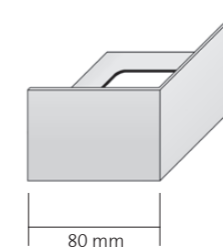
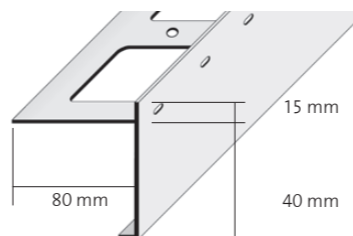



DURABAL BW

DURABAL BW are L-shaped balcony angle profiles for the elegant edging of exposed edge areas of flooring constructions.

For installation heights up to 95 mm.

Available in a wide range of RAL colours, they fit harmoniously in the overall decorative scheme.



DURABAL BW

L-shaped angle profile for balconies and terrasses, for clean termination and edge protection.

L-shaped angle profile for installation in thin-bed adhesive

DURABAL BW

DURABAL BW Base profile

with additional drill holes

Material Aluminium powder coated

Base size 85 mm, Length 300 cm

Height 55 mm

BWAC 5532 RAL 1019 beige

BWAC 5533 RAL 8019 black-brown

BWAC 5535 RAL 8003 brown

BWAC 5538 RAL 7035 grey

Height 75 mm

BWAC 5532 RAL 1019 beige

BWAC 5533 RAL 8019 black-brown

BWAC 5535 RAL 8003 brown

BWAC 5538 RAL 7035 grey

Height 95 mm

BWAC 5532 RAL 1019 beige

BWAC 5533 RAL 8019 black-brown

BWAC 5535 RAL 8003 brown

BWAC 5538 RAL 7035 grey

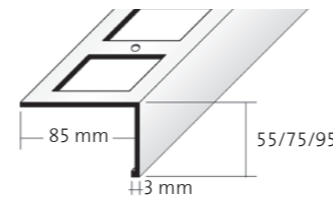

RAL 1019

RAL 8019

RAL 8003

RAL 7035

DURABAL BW Corner piece

Material Aluminium powder coated

Height 55 mm

BWAC 5532-X RAL 1019 beige

BWAC 5533-X RAL 8019 black-brown

BWAC 5535-X RAL 8003 brown

BWAC 5538 RAL 7035 grey

Height 75 mm

BWAC 7532-X RAL 1019 beige

BWAC 7533-X RAL 8019 black-brown

BWAC 7535-X RAL 8003 brown

BWAC 7538-X RAL 7035 grey

Height 95 mm

BWAC 9532-X RAL 1019 beige

BWAC 9533-X RAL 8019 black-brown

BWAC 9535-X RAL 8003 brown

BWAC 9538-X RAL 7035 grey

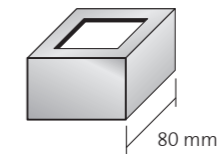

DURABAL BW Connector

Material Aluminium powder coated

Height 55 mm

BWAC 5532-XC RAL 1019 beige

BWAC 5533-XC RAL 8019 black-brown

BWAC 5535-XC RAL 8003 brown

BWAC 5538-XC RAL 7035 grey

Height 75 mm

BWAC 7532-XC RAL 1019 beige

BWAC 7533-XC RAL 8019 black-brown

BWAC 7535-XC RAL 8003 brown

BWAC 7538-XC RAL 7035 grey

Height 95 mm

BWAC 9532-XC RAL 1019 beige

BWAC 9533-XC RAL 8019 black-brown

BWAC 9535-XC RAL 8003 brown

BWAC 9538-XC RAL 7035 grey

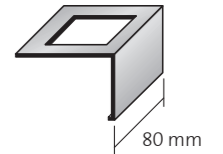

Material Stainless steel (304) natural

Base size 85 mm, Length 300 cm

BWE 55 Height 55 mm

BWE 75 Height 75 mm

BWE 95 Height 95 mm



Material Stainless steel (304) natural

BWE 55-X Height 55 mm

BWE 75-X Height 75 mm

BWE 95-X Height 95 mm



Material Stainless steel (304) natural

BWE 55-XC Height 55 mm

BWE 75-XC Height 75 mm

BWE 95-XC Height 95 mm

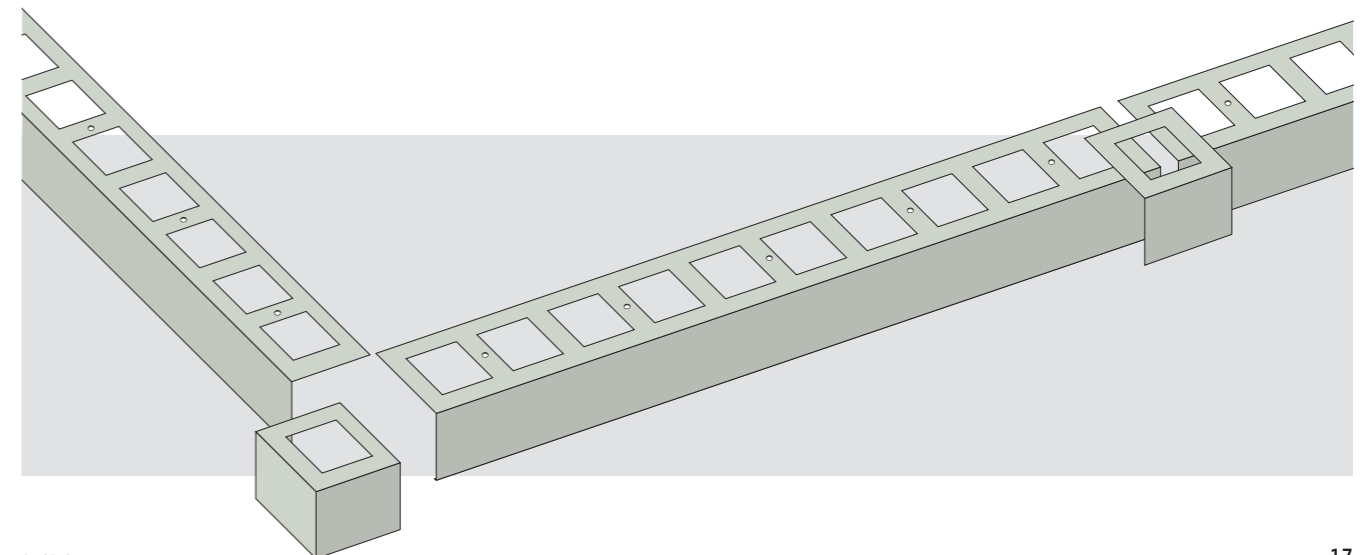



DURABASE DD 80++

ideal for creating large surface drainage areas in combination with tiled, natural and artificial stone flooring. The mat can be laid in a gravel/stone bed, in drainage screed and even directly onto the film (without support plates).

Suitable for heavy surcharge loading.

Very high drainage capacity.

Thanks to the special layout of the dimples with varying heights of 6 and 8 mm, it is possible to produce a drainage area that is large enough in the long run even for high loads. The space between the dimples and the mesh fabric also allows the floor construction to dry out rapidly. In addition, the seal is fully protected from thermal and mechanical loading.

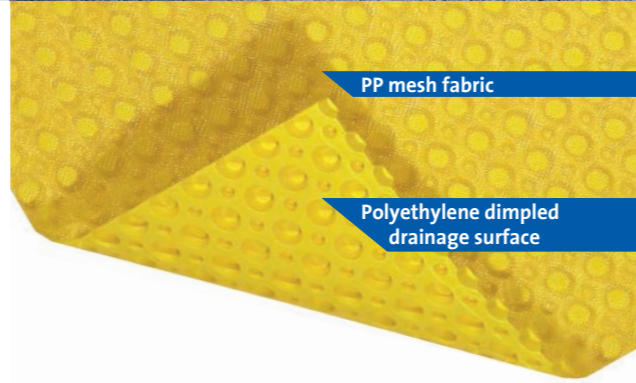

DURABASE DD 80++

Material Polypropylene yellow

Height 8 mm, Width 1000 mm

Pallet 9 Rolls (112.5 m²)

Single roll = Roll length 12.5 m

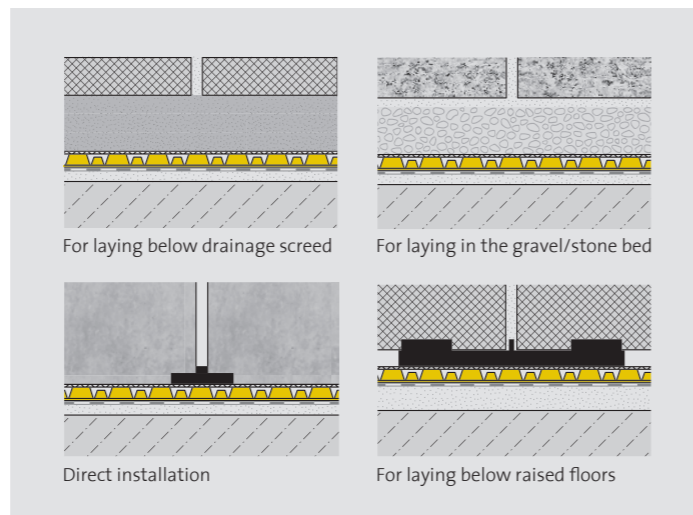

DURABASE DD 80++

Drainage mat for highly water permeable flooring constructions outdoors.



DURABASE DD 80

ideal for creating large surface drainage areas in combination with tiled, natural and artificial stone flooring.

Drainage channels on both sides.

Installation under screed and gravel-bed.

Moisture which seeps into the flooring construction is drawn away efficiently by the drainage surface created by the dimples. Thanks to the special layout of the drainage channels, any water which occurs can also be drawn off below the mat (dual drainage).

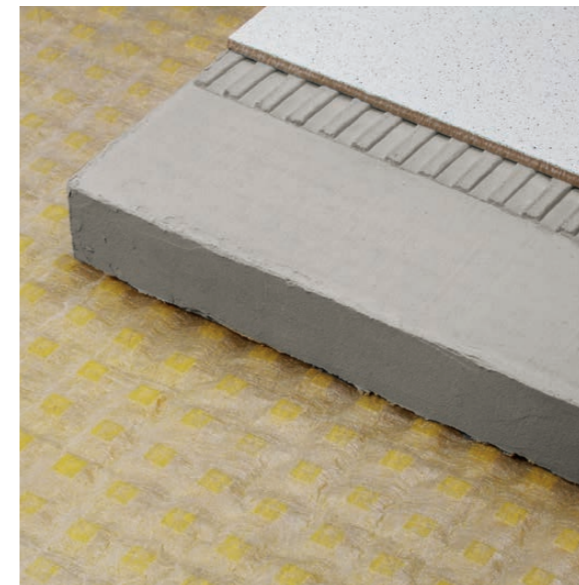

DURABASE DD 80

Material Polypropylene yellow

Height 8 mm, Width 1000 mm

Pallet = 9 Rolls (135 m²)

Single roll = Roll length 15 m

DURABASE DD 80

Matting system for the dual drainage of tiled flooring outdoors.

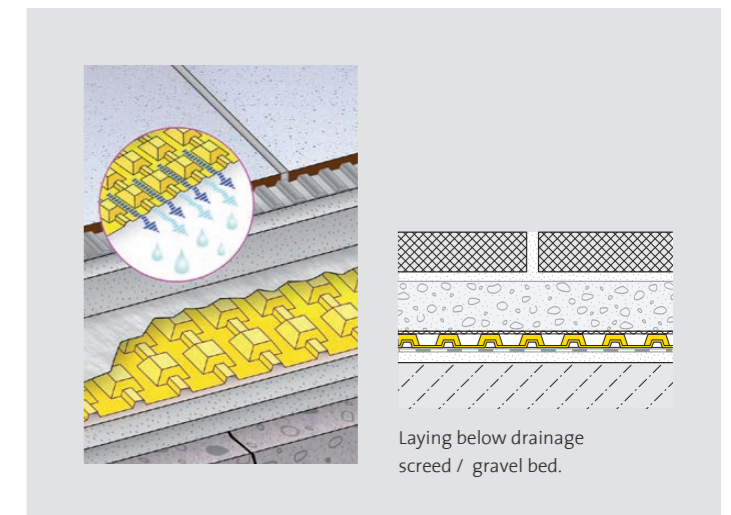



DURABASE CI++

The matting system for decoupling with a sealing effect for tiled and natural stone surfaces in indoor and outdoor areas.

The crack-bridging properties of the mat make it ideally suited for use in renovation projects. It allows new tiles to be laid on old and damaged tiled floors, provided that these are still load-bearing.

On balconies and patios, DURABASE CI++ provides an additional bonded seal in conjunction with the tiles and prevents water from percolating through.

Its high elasticity ensures good crack-bridging properties making it particularly suitable for use on difficult subsurfaces such as wood, mastic asphalt and relatively fresh cement and anhydrite screeds.

3. Woven mesh

2. Dimpled structure

1. Underlay fabric

DURABASE CI++

Crack-bridging decoupling mat with shearing force protection for indoor and outdoor areas.

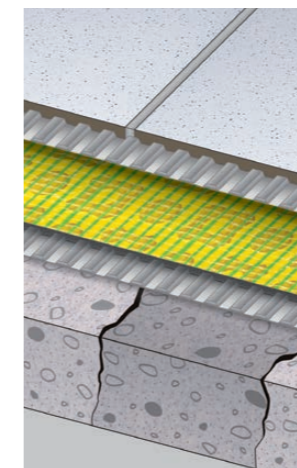
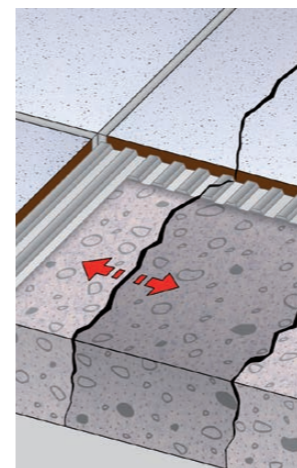

The problem

Movements in the subfloor can cause cracks to form in the tiled surface, or old and damaged subfloor (such as wooden floors) are unsuitable for tiling onto directly.

The solution

The installation of a DURABASE CI++ mat ensures that smaller cracks in the subsurface are absorbed; the tiles are decoupled and the cracks are passed into the tiles. This makes it possible to lay new tiles on old and problematic yet still load-bearing surfaces.

The advantages

- High shear elasticity
- Quick and easy installation
- Optimum installation quality
- Shear-stress optimised
- Tiles can be laid once the floor screed can be walked on
- Ideal for renovation projects
- Sealing in outdoor areas

DURABASE CI++ Accessories for waterproofing of pipe connections and matting junctions. Permanently watertight.

WPFXI Internal corner,

WPFX External corner

WPFM 120, WPFM 425 Pipe collar

WP 150-30/-05, WP 120-10/-05 Sealing tape

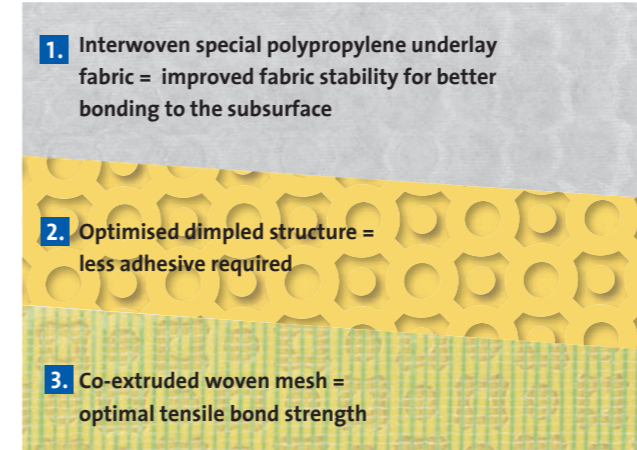
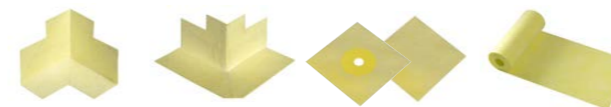

1. Interwoven special polypropylene underlay fabric = improved fabric stability for better bonding to the subsurface

2. Optimised dimpled structure = less adhesive required

3. Co-extruded woven mesh = optimal tensile bond strength



DURABASE CI++

Material Polypropylene yellow

Width 1000 mm, Height 3 mm

Pallet with 24 Rolls à 5 m² = 120 m²

Pallet with 16 Rolls à 10 m² = 160 m²

Pallet with 6 Rolls à 30 m² = 80 m²

single roll = 1 Roll à 5 qm

single roll = 1 Roll à 10 qm

single roll = 1 Roll à 30 qm

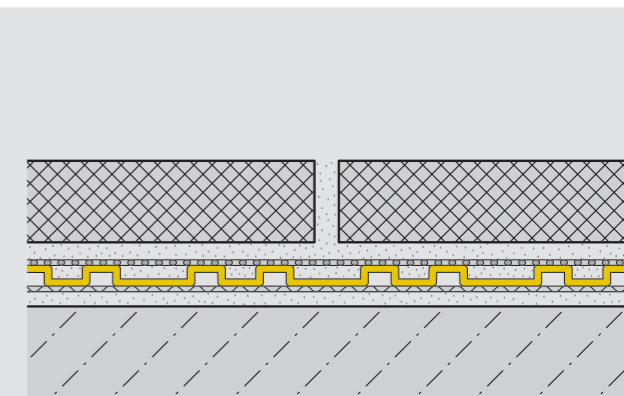

U-DRAIN

High-quality PVC drainage channel system with an elegant grating in anodised aluminium.

Equipped with a full block Styropor assembly aid in the factory, which protects the channel from contamination and deformation throughout the entire installation phase.

Suitable for access by vehicles with a max. wheel load of 1.100 kg.

Outstanding self-cleaning properties thanks to the ultra-smooth inner surface of the channels.

Complete accessory program.



U-DRAIN

High-quality PVC drainage channel system with an elegant grating in anodised aluminium for the indoor and outdoor area.

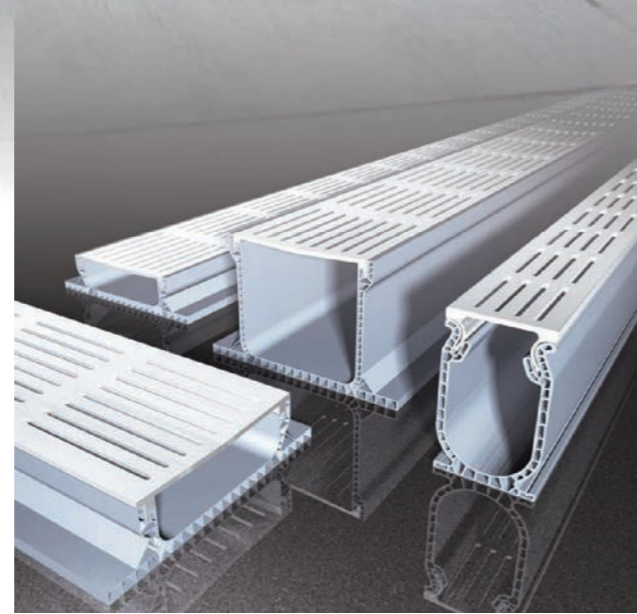

U-DRAIN

Drainage channel incl. aluminium grate and assembly assistance

Material Aluminium/PVC,

Aluminium grating – salt water resistant.



U 40

Drain outlet capacity 295 l/min.

grate size 100 mm, Height 40 mm

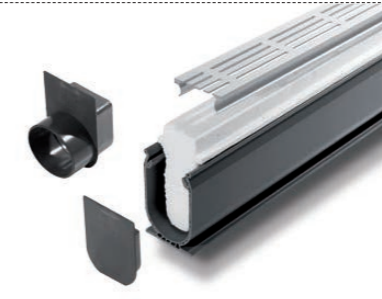

U 60

Drain outlet capacity: 500 l/min..

grate size 60 mm, Height 100 mm

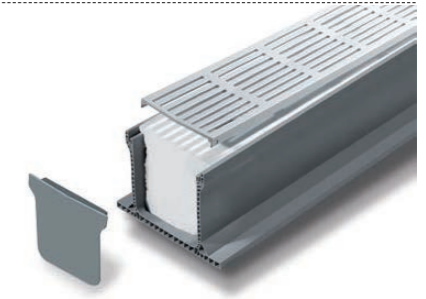

U 100

Drain outlet capacity: 825 l/min.

grate size 100 mm, Height 100 mm

Accessories Material PVC

	U 40	U 60	U 100
End cap	U 40-EC	U 60-EC	U 100-EC
Connector	U 40-J	U 60-J	U 100-J
T-Piece incl. connector, without grate	U 40-T	U 60-T	U 100-J
Corner Piece incl. grate	U 40-RT	U 60-RT	U 100-J
Vertical drain outlet incl. connector, without grate	U 40-T	U 60-T	U 100-J
Horizontal drain outlet	-	U 60-EO	U 100-EO
Side drain outlet incl. connector, without grate	-	U 60-SO	U 100-SO
Spigot	U 40-SP	-	-

U-PVC glue

Contains solvents

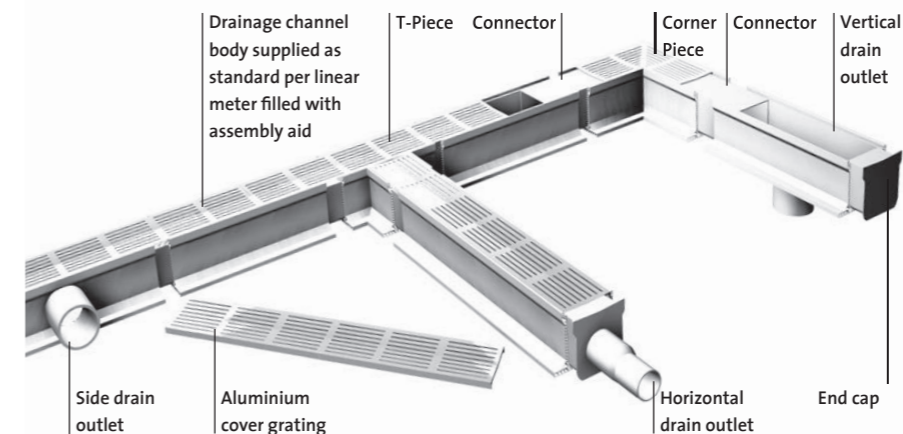

Aluminium grating – salt water resistant

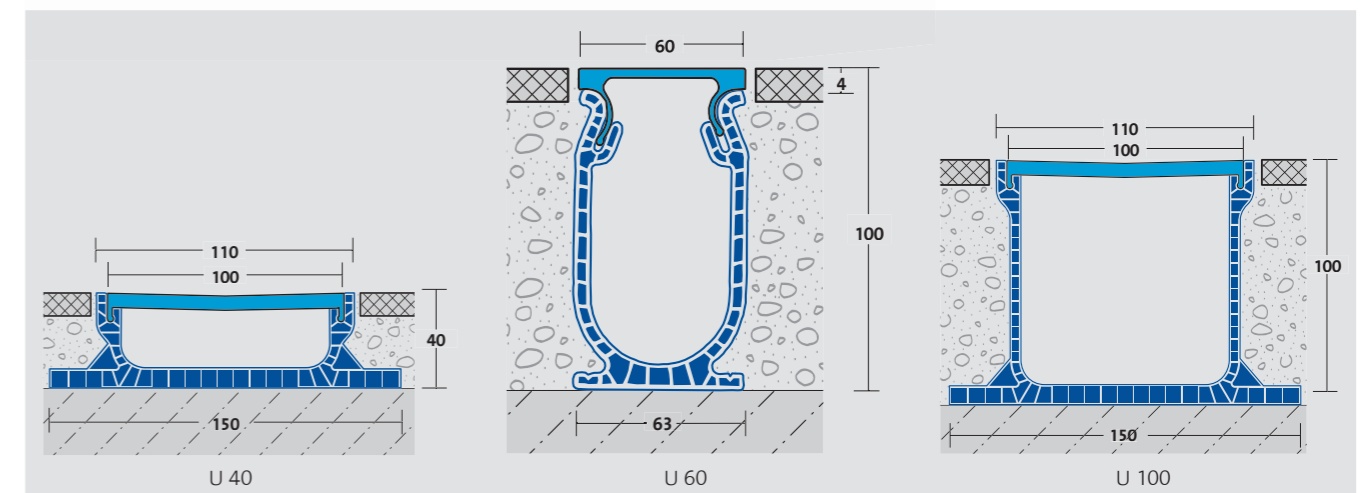
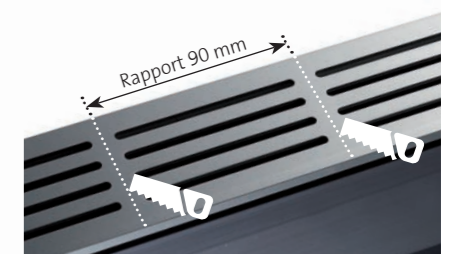

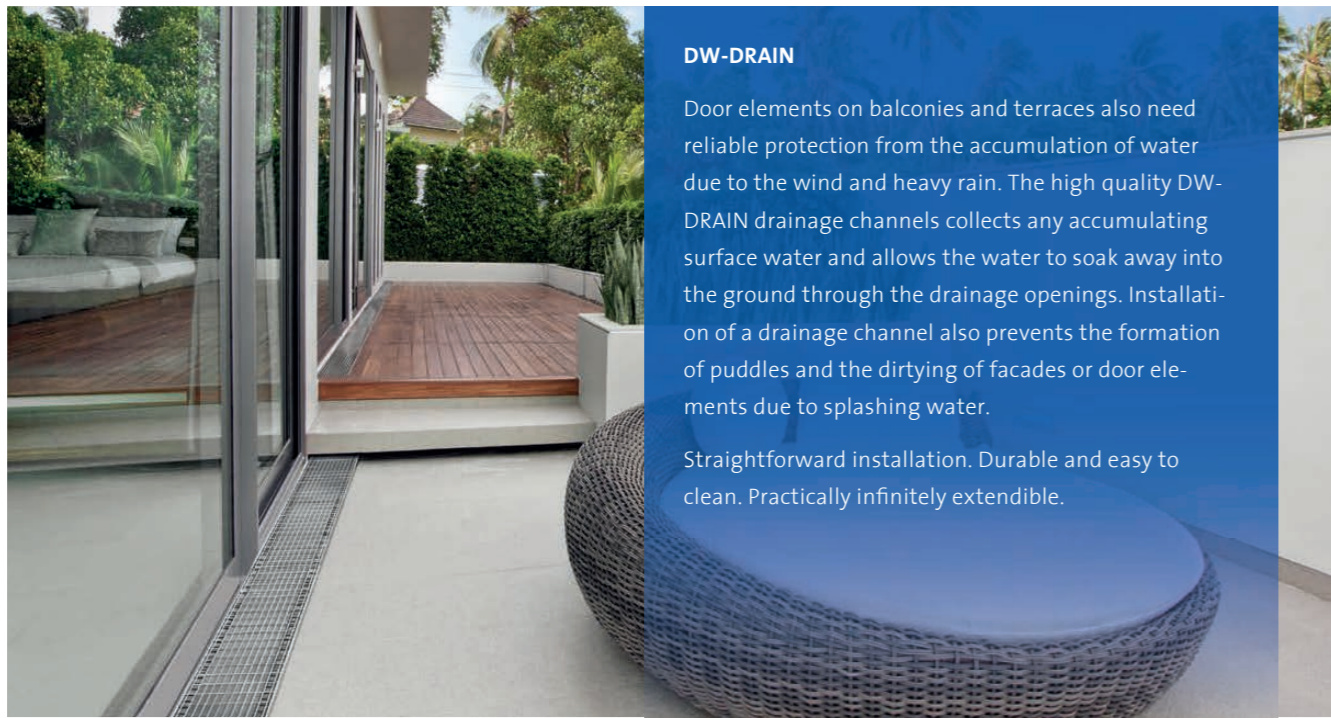

DW-DRAIN

Door elements on balconies and terraces also need reliable protection from the accumulation of water due to the wind and heavy rain. The high quality DW-DRAIN drainage channels collect any accumulating surface water and allows the water to soak away into the ground through the drainage openings. Installation of a drainage channel also prevents the formation of puddles and the dirtying of facades or door elements due to splashing water.

Straightforward installation. Durable and easy to clean. Practically infinitely extendible.



DW-DRAIN 100

Drainage channel incl. grate

Width 100 mm, Height 40 mm, Length 100 cm

DWD-VZ 40-100 galvanised steel

DWD-E 40-100 Stainless steel (304)

End cap

DWD-VZ 40-100-XK galvanised steel

DWD-E 40-100-XK Stainless steel (304)

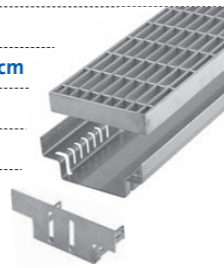

DW-DRAIN 140

Drainage channel incl. grate

Width 140 mm, Height 40 mm, Length 100 cm

DWD-VZ 40-140 galvanised steel

DWD-E 40-140 Stainless steel (304)

End cap

DWD-VZ 40-140-XK galvanised steel

DWD-E 40-140-XK Stainless steel (304)

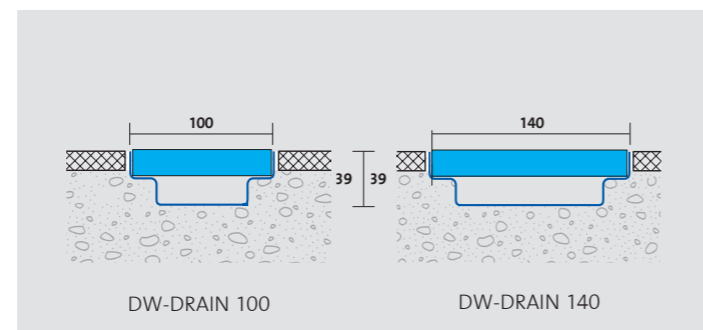
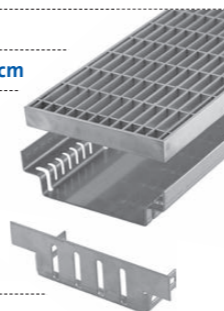

DW-DRAIN

Drainage channel system for a steady discharge of water via the drainage level of the flooring.

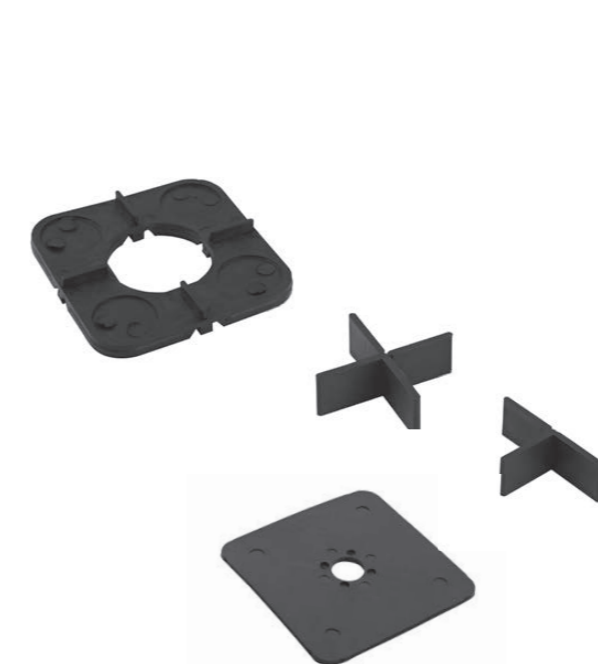

SUPPORT PLATES

for large-format tiles

Dimension 100 x 100 x 9 mm

Material Caoutchoc

black, Height 9 mm

BLST 1209



COMPENSATION PLATE

compensation plate for support tiles

Dimension 100 x 100 x 2 mm

Material Caoutchoc

black, Height 2 mm

BLSTA 1002

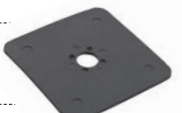

TILE SPACER

for large-format tiles

Material PVC

black

BLFK 355 **Height 15 mm** 35 x 35 x 5 mm

BLFK 455 **Height 30 mm** 45 x 45 x 5 mm

BLFK 603 **Height 20 mm** 60 x 60 x 3 mm



TILE SPACER T-PIECE

for large-format tiles

Material PVC

black

BLTS 355 **Height 15 mm** 35 x 35 x 5 mm

BLTS 455 **Height 30 mm** 45 x 45 x 5 mm



ACCESSORIES

Material for the Installation of concrete and ceramic plates in square and rectangular format on terrace and balcony.



DURAWAY Ready-made mats
Walk-off zones can be installed at all entrance and porch areas, with DURAWAY ready-assembled mats in two sizes and two neutral colours: black and light grey.

DURAWAY Easy
Extremely durable. Very easy to clean. Anti-slip. Suitable for use indoors and outdoors. Resistant to heat and cold. Leading edge and closing edge in aluminium.

DURAWAY Doormat and frame system
A choice of six different doormat system configurations is available to suit the architecturally important entrance and transitions areas in your building. DURAWAY always collects the dirt precisely at those locations where it would otherwise be constantly brought into the building. The installation height of 10 mm is ideal for incorporating in existing flooring.



Illustration: DURAWAY floor mat system with ribbed and rubber inserts and DURAWAY angle frame stainless steel

DURAWAY

Entrance mat-/ Framesystem

Premium doormat- and framesystem for all requirements. Individually configurable or in standard formats.

DURAWAY Ready-made mat

Ready-to-install doormat and frame system

Material Aluminium, Ribs

Height 10 mm, 60 x 40 (without frame)

DWR 1033-6040 black (33)

DWR 1033-6040 light grey (97)

Height 10 mm, 80 x 60 (without frame)

DWR 1033-8060 black (33)

DWR 1033-6040 light grey (97)



DURAWAY Easy

Ready-to-install doormat and frame system

Material Alu/PVC/Nylon, Brush black

Height 22 mm, 600 x 375 mm

DWBA 2000/S

Height 22 mm, 785 x 475 mm

DWBA 2000/M



DURAWAY Angle frames

for DURAWAY door mats

Material Aluminium

Height 10 mm, for standard mat 60 x 40 cm

DWRA 1030-6040

Height 10 mm, for standard mat 80 x 60 cm

DWRA 1030-8060

DURAWAY

Frame system for DURAWAY door mats

Aluminium	Stainless steel (304)	for height
-----------	-----------------------	-------------------

DWRA 1030	DWRE 1030	10 mm
-----------	-----------	--------------

DWRA 1730	DWRE 1720	17 mm
-----------	-----------	--------------

DWRA 2225	DWRE 2225	22 mm
-----------	-----------	--------------

DWRA 2730	DWRE 2730	27 mm
-----------	-----------	--------------

DURAWAY

Ready-to-install doormat and frame system

Material Aluminium; Ribs; Caoutchouc; Brush

Width 1000 mm, Height 10 mm

DW1000 R Ribs*, DW1000 C Caoutchouc, DW1000 RC Ribs/Caoutchouc, ***- K Scraper bar

Width 1000 mm, Height 17 mm

DW1700 R Ribs*, DW1700 C Caoutchouc, DW1700 B Brush, DW1700 RC Ribs/Caoutchouc, DW1700 BR Brush/Ribs, DW1700 BC Ribs/Caoutchouc, ***- K Scraper bar

Width 1000 mm, Height 22 mm

DW2200 R Ribs*, DW2200 C Caoutchouc, DW2200 B Brush, DW2200 RC Ribs/Caoutchouc, DW2200 BR Brush/Ribs, DW2200 BC Ribs/Caoutchouc, ***- K Scraper bar

Width 1000 mm, Height 27 mm

DW2700 R Ribs*, DW2700 Caoutchouc, DW2700 B Brush, DW2700 RC Ribs/Caoutchouc, DW2700 BR Brush/Ribs, DW2700 BC Ribs/Caoutchouc, ***- K Scraper bar



ENTRY construction

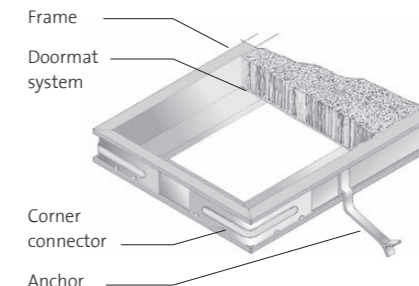

ENTRY Frame system

for two different heights

Length 300 cm

Aluminium silver anodised

EFAE 1823 **Height 23 / 18 mm**

Brass natural

EFM 1823 **Height 23 / 18 mm**

DURAWAY Ribs colours (Fire class B)*:



Caoutchouc colours:



Brush colours:

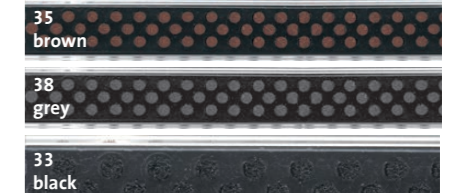

Scraper bar :

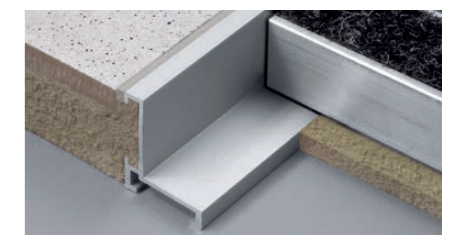

ENTRY Accessories

Angle connector for frame system ENTRY

Material Iron galvanised

ENTRY EV 1823

Anchor for frame system ENTRY

Material Brass natural

ENTRY EA 1823

DURAL is a comprehensive provider of floor-level shower systems, profiles and matting systems for walls and floors

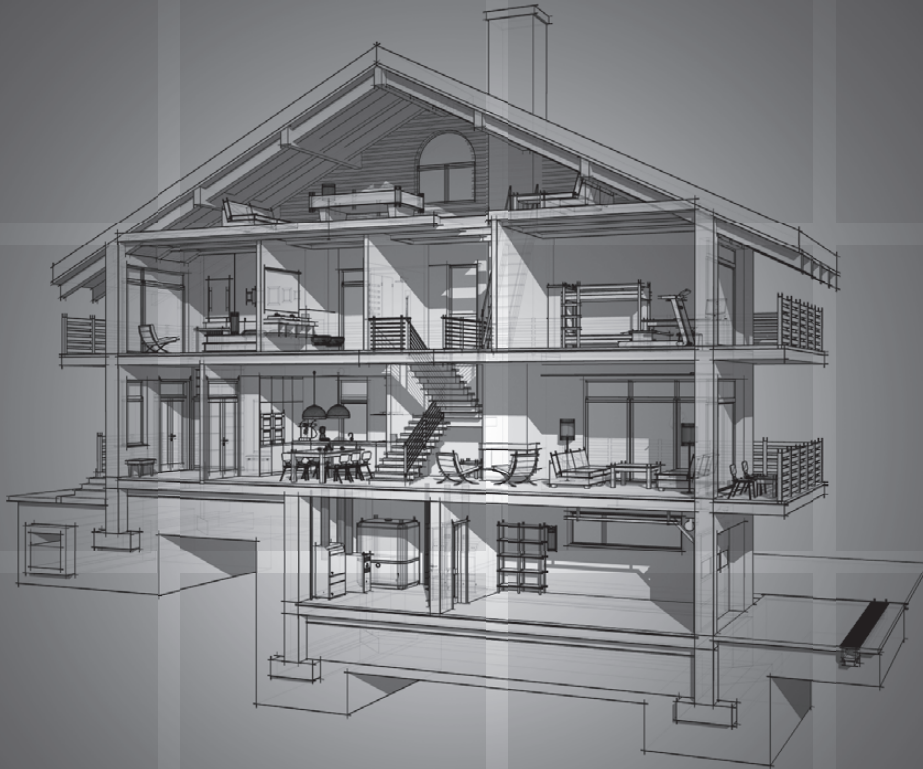

Profiles for tiles
Expansion joint profiles
Matting systems

Floor level shower systems / Drains
LED
Skirting profiles

Profiles for balconies and terraces
Doormat systems
Stair nosing profiles

Flooring surface profiles
Tactile orientation aids

Recommended by:

DURAL GMBH
Südring 11
D-56412 Ruppach-Goldhausen
Tel. +49 [0] 2602/9261-0
Fax +49 [0] 2602/9261-50
info@dural.com
www.dural.com